

VERSION	CHANGE CONTENT	DATE
V00	FIRST ISSUE	2007-07-27

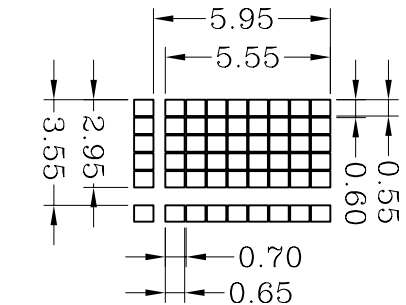
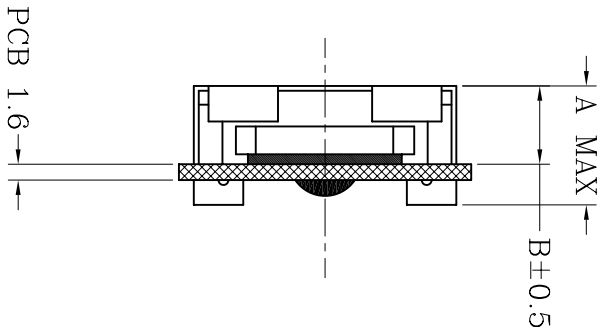
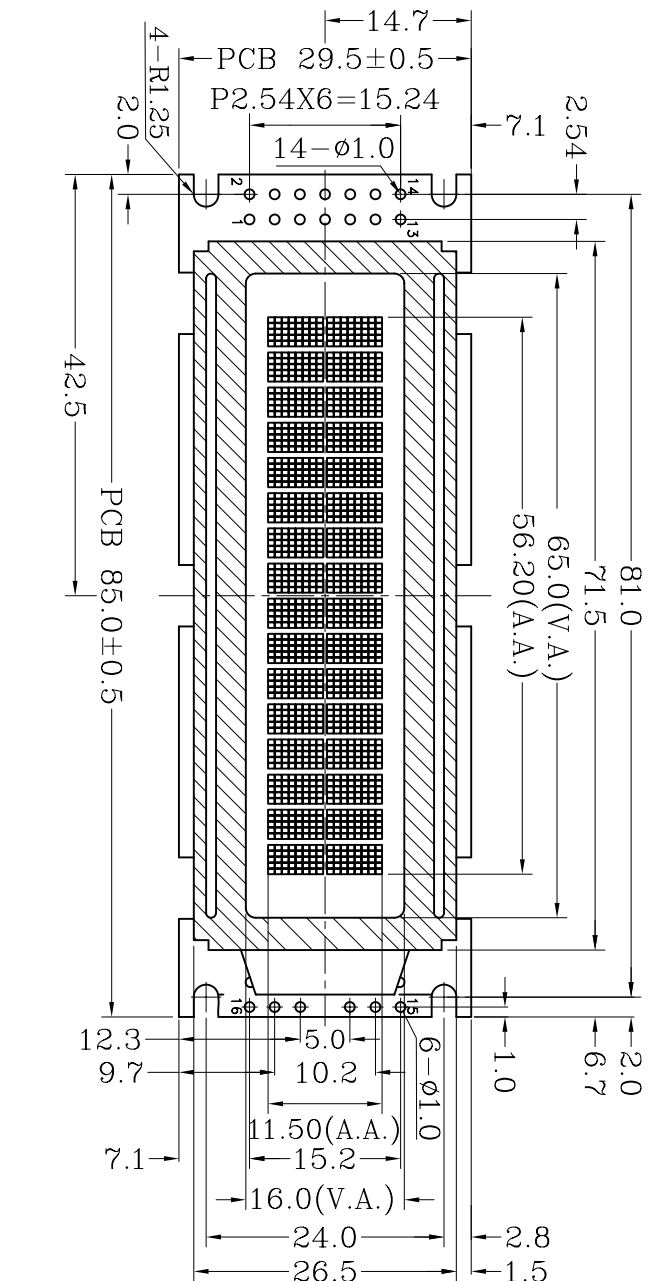

VIEWING

PIN	1	2	3	4	5	6	7	8	9	10	11	12	13	14	15	16
NAME	VDD	VSS	V0	RS	R/W	E	DB0	DB1	DB2	DB3	DB4	DB5	DB6	DB7	LED+	LED-

SPECIFICATIONS

1. DISPLAY TYPE: STN/TRANSMISSIVE/NEGATIVE/BLUE
2. LCD DRIVING VOLTAGE: 5.0V
3. LOGIC VOLTAGE: 5.0V
4. VIEWING DIRECTION: 6 O'CLOCK
5. OPERATING TEMP: -10° C~60° C
6. STORAGE TEMP: -20° C~70° C
7. DRIVE MODE: 1/16 DUTY,1/5 BIAS
8. BACKLIGHT: WHITE/SIDE BACKLIGHT/5.0V
9. CONTROL/DRIVE IC: SPLC780D-001B-C/SPL100A2-C
10. OTHER:

NOTE:

DESCRIPTION:

C/D

SCALE: FIT	TINSHARP	TINSHARP
SHEET: 1 OF 1	ELECTRONICS CO.,LTD.	

UNIT: mm	MODEL	SERIAL NUMBER
PROJECTION	TC1602E-13T	MLX0208
APP:	CHK:	DWN:
DATE:	DATE:	DATE:

SCALE: 4:1

DETAIL DOTS